



1567 Way to Grace
Pocatello, Idaho 83201
Phone: 208-235-7659
www.MECEventCenter.com

MEC – The Right Equipment for Your Event

The MEC has the highest quality equipment for your event. Just a partial list includes:

- 40,000 sq. ft. multipurpose event center
- 28,000 sq. ft. open span gym area (178'6" x 158')
- 2 Full size high school basketball courts (84'x50') and 1 Full size college basketball court
- 6 regulation size volleyball courts
- 10 pickleball courts
- Bleacher seating for ~1,000
- Full PA System
- 50 round tables (Accommodates 500 people)
- 50 6 ft tables
- 500 Chairs
- Carpet cover to protect our hardwood floor
- 2 Projector screens
- Conference room with 18' table and seating for ~15
- 2 Official rooms
- 2 Locker rooms
- Medical room
- Full service concession area

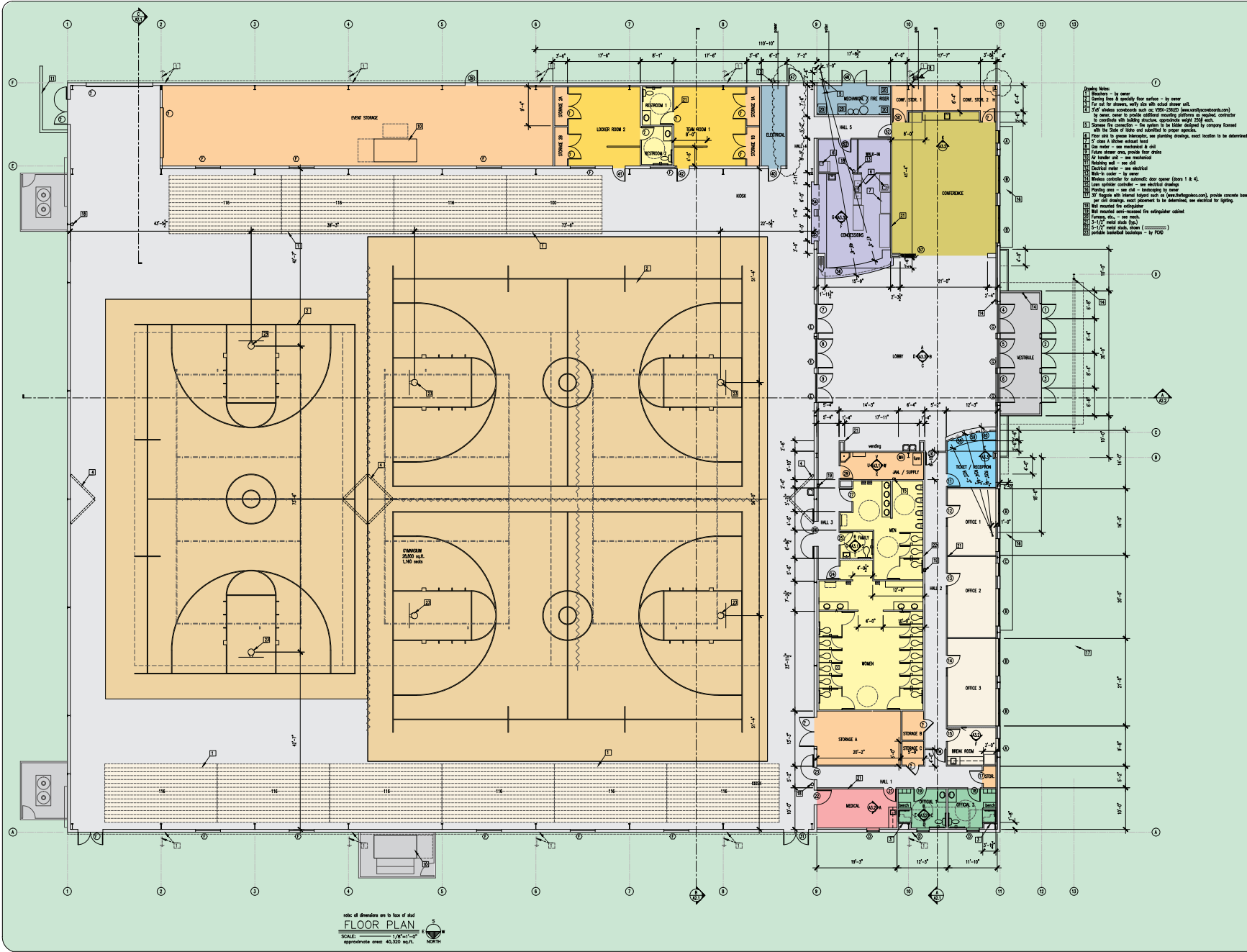

- Legend:**
- Elevator - by owner
 - Corridor lines & specialty floor surface - by owner
 - For use by others, with fire with rated egress exit.
 - All window assemblies with eq. VENT-200LD (www.ventilation.com) to meet, meet to frame additional mounting, provide no. window, contractor to provide and fabricate window, operation weight limit.
 - Schedule the connection - fire system to be fabric designed by company formed with the City of state and submitted to their agency.
 - Door sets to glass fabricator, see planning drawings, exact location to be determined
 - 1" door & thicker egress door
 - Gas meter - see mechanical & civil
 - Extra egress area, provide floor areas
 - 6" header sill - see mechanical
 - Lobby sill - see civil
 - District meter - see electrical
 - 6" to 12" - see owner
 - Window operable by automatic door opener (zone 1 & 4).
 - Low window operable - see electrical drawings
 - Heating area - see civil - manufacturer by owner
 - All facade with thermal break such as (www.fablog.com), provide concrete base per all drawings, exact placement to be determined, see detailed to lighting.
 - Wall mounted fire extinguisher
 - Full mounted non-vented fire extinguisher cabinet
 - Furnace, etc. - see mech.
 - 1-1/2" metal deck (top)
 - 5-1/2" metal deck, show (---) ---
 - provide handrail supports - by FCM

note: all dimensions are to face of steel
FLOOR PLAN
 SCALE: 1/8" = 1'-0"
 approximate area: 40,320 sq.ft.
 NORTH



BOOTH
 Architecture PLLC